



GradyMinor
Civil Engineers
Landscape Architects
Land Surveyors
Planners

Bonita Springs 239.947.1144
Fort Myers 239.690.4380

www.GradyMinor.com
Richard P. Chalupa, RLA

License No. 6667463

LANDSCAPE LANDSCAPE PLANS

THE CITY OF NAPLES
for

CHARLIE C. ANTHONY PARK

CONTACTS:

CITY OF NAPLES :
JIM HODGDON
PARKS AND PARKWAYS SUPERINTENDENT
jhodgdon@naplesgov.com
239-213-7134

LANDSCAPE ARCHITECT:
RICHARD P. CHALUPA
Q. GRADY MINOR & ASSOCIATES, P.A.
rchalupa@gradymenor.com
239-947-1144

IRRIGATION DESIGNER:
RICK MANLEY
RAM DESIGN
ramdesign63@gmail.com
239-287-2559

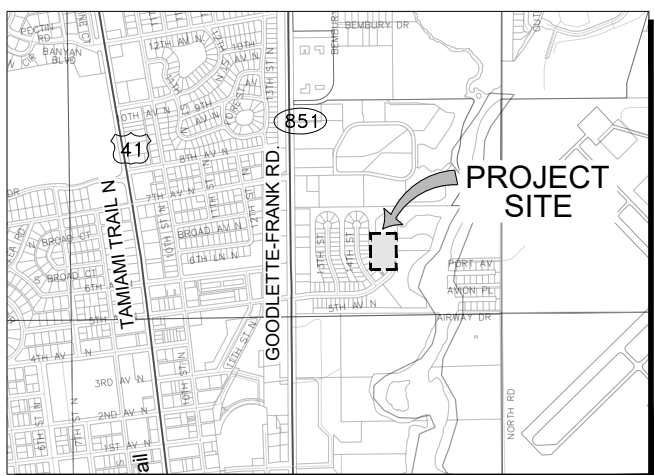

VACINITY MAP
SCALE: Custom

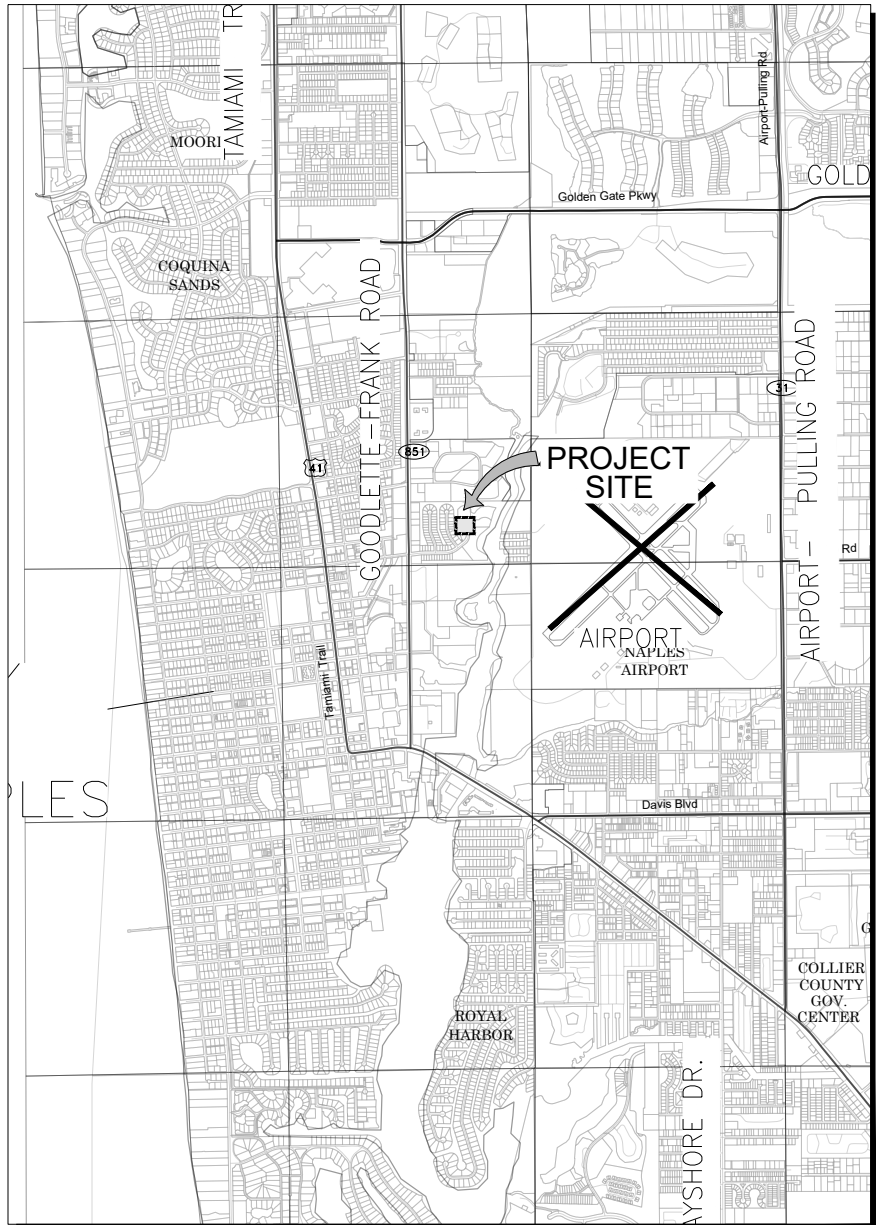

LOCATION MAP
SCALE: Custom

LANDSCAPE ARCHITECTURAL PLANS	
TABLE OF CONTENTS	
Dwg. No.	Description
1	COVER SHEET
2	LANDSCAPE PLAN (1)
3	LANDSCAPE PLAN (2)
4	PLANTING SCHEDULE
5	DETAILS SHEET



INVESTIGATE
BEFORE YOU
EXCAVATE



"CALL SUNSHINE"
1-800-432-4770

TOLL FREE
FL. STATUTE 553.851 (1979) REQUIRES
MIN. OF 2 DAYS AND MAX. OF 5 DAYS
NOTICE BEFORE YOU EXCAVATE.

CHARLIE C. ANTHONY PARK
LANDSCAPE PLAN
CITY OF NAPLES, FLORIDA

REVISIONS

SHEET
1 OF 5

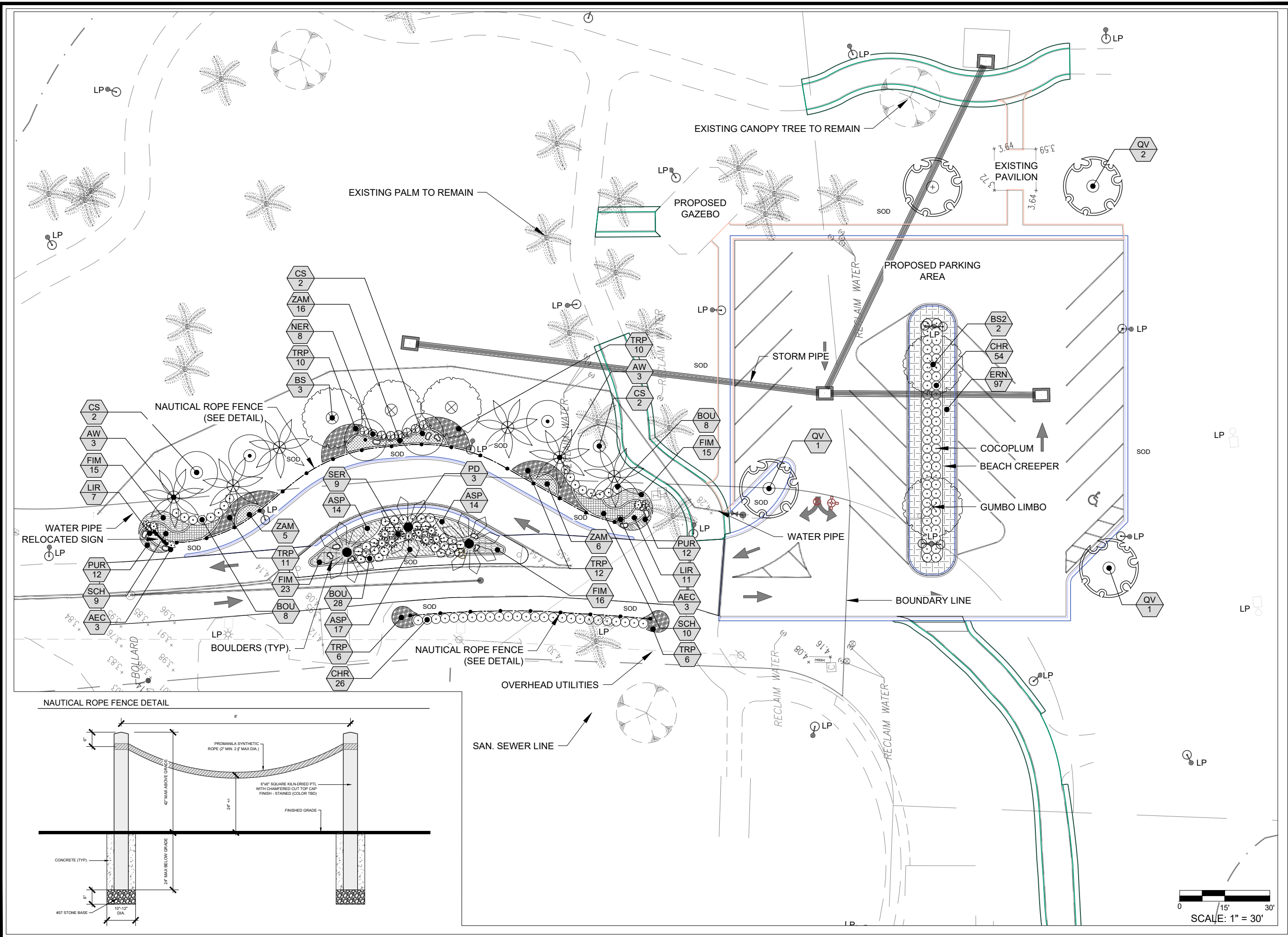

GradyMinor
 Civil Engineers
 Landscape Architects
 Land Surveyors
 Planners

Bonita Springs 239.947.1144
 Fort Myers 239.690.4380

www.GradyMinor.com

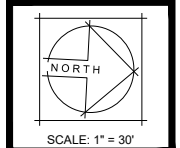

CHARLIE C. ANTHONY PARK
LANDSCAPE PLAN (1)
CITY OF NAPLES, FL

REVISIONS

SHEET
2 OF 5

DATE: MAY 2022

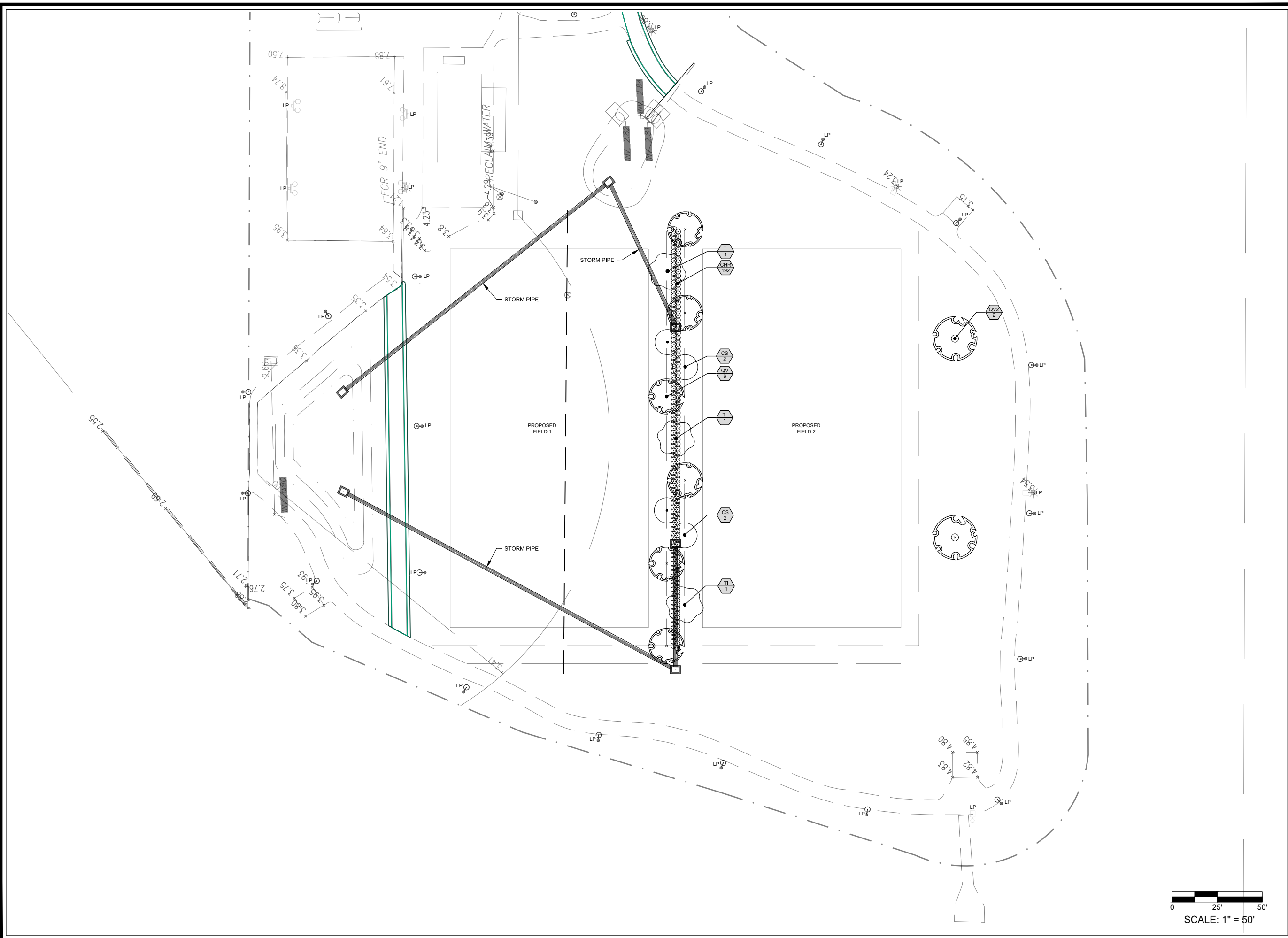

GradyMinor

Civil Engineers
Landscape Architects
Land Surveyors
Planners

Bonita Springs 239.947.1144
Fort Myers 239.690.4380

www.GradyMinor.com

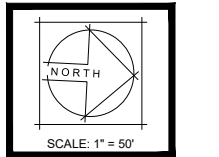
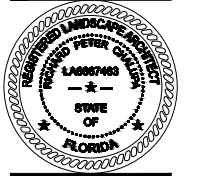

CHARLIE C. ANTHONY PARK
LANDSCAPE PLAN (2)
CITY OF NAPLES, FL

REVISIONS

SHEET
3 OF 5

DATE: MAY 2022

G:\LANDSCAPE\C\014-ANTHONY PARK\01-DWG\BETTERMENT\014-LA-BTR.DWG 5/2/2022 8:55 AM

MASTER PLANT SCHEDULE

TREES	CODE	QTY	BOTANICAL NAME	COMMON NAME	HT. AND SPR.	CALIPER	SPEC.	NATIVE	
	BS	3	Bursera simaruba	Gumbo Limbo	12' ht. min. x 4' spd. min.	3" cal. min.	Full crown	Yes	
	BS2	2	Bursera simaruba	Gumbo Limbo	12' ht. min. x 4' spd. min.	3" cal. min.	Full crown	Yes	
	CS	10	Conocarpus erectus sericeus	Silver Buttonwood	12' ht. min. x 4' spd. min.	3" cal. min.	Full crown	Yes	
	QV	10	Quercus virginiana	Southern Live Oak	12' ht. min. x 4' spd. min.	3" cal. min.	Full crown	Yes	
	QV2	2	Quercus virginiana	Southern Live Oak	16'-18' OA Ht.	4" cal. min.	Full crown	Yes	
	TI	3	Tabebuia impetiginosa	Pink Trumpet Tree	12' ht. min. x 4' spd. min.	3" cal. min.	Full crown	No	
PALMS	CODE	QTY	BOTANICAL NAME	COMMON NAME	HT. AND SPR.	CALIPER	SPEC.	NATIVE	
	AW	6	Acoelorrhaphe wrightii	Paurotis Palm	10' O.A. Planted	Multiple	Full Crown, Matching	Yes	
	PD	3	Phoenix dactylifera	Medjool Palm	10' G.W.	Heavy	Straight trunk, Matching, Full Crown	No	
SHRUBS	CODE	QTY	BOTANICAL NAME	COMMON NAME	SIZE	HT. AND SPR.	SPACING	NATIVE	
	AEC	6	Aechmea blanchetiana	Orange Bromeliad	7 gal	24" - 30" ht., 18" - 24" spd.	per plan	No	
	BOU	44	Bougainvillea x 'BK'	Barbara Karst Bougainvillea	3 gal. min.	18"-24" Ht. x 18"-24" Spr.	36" oc	No	
	CHR	272	Chrysobalanus icaco 'Red Tip'	Red Tip Cocoplum	3 gal. min.	18"-24" Ht. x 18"-24" Spr.	36" oc	Yes	
	NER	8	Nerium oleander 'Petite Red'	Petite Red Oleander	3 gal. min.	18"-24" Ht. x 18"-24" Spr.	36" oc	No	
	SER	9	Serenoa repens 'Cinerea'	Silver Saw Palmetto	7 gal.	24" - 30" ht., 18" - 24" spd.	per plan	Yes	
SHRUB AREAS	CODE	QTY	BOTANICAL NAME	COMMON NAME	SIZE	HT. AND SPR.	SPACING	NATIVE	SPACING
	ASP	45	Asparagus densiflorus 'Myers'	Myers Asparagus Fern	3 gal	12" - 18" ht., 12" - 18" spd.	24" oc	No	24" o.c.
	FIM	69	Ficus microcarpa 'GI'	Green Island Fig	3 gal	12" - 18" ht., 12" - 18" spd.	24" oc	No	24" o.c.
	SCH	19	Schefflera arboricola 'Variegata'	Dwarf Variegated Schefflera	3 gal	18" - 24" ht., 12" - 24" spd.	36" oc	No	36" o.c.
	TRP	55	Tripsacum dactyloides	Fakahatchee Grass	3 gal	18"-24" Ht. x 18"-24" Spr.	36" oc	Yes	36" o.c.
	ZAM	27	Zamia floridana	Coontie Palm	3 gal	12" - 18" ht., 12" - 18" spd.	30" oc	Yes	30" o.c.
GROUND COVERS	CODE	QTY	BOTANICAL NAME	COMMON NAME	SIZE	HT. / SPR. / SPEC.	SPACING	NATIVE	SPACING
	ERN	97	Ernodea littoralis	Golden Creeper	3 gal	18" ht. x 18" spd.	36" oc	Yes	36" o.c.
	LIR	18	Liriope muscari	Lilyturf	1 gal.	12" ht.	18" oc	No	18" o.c.
	PUR	24	Tradescantia pallida	Purple Spiderwort	1 gal.	12" ht.	18" oc	No	18" o.c.

SOD, MULCH and ROOT BARRIER

SOD	TBD	SOD ALL PROPOSED SOD BEDS WITH STENOTAPHRUM SECUNDATUM - ST. AUGUSTINE FLORATAM SOD NOTED AS "SOD" ON PLAN.
BAHIA	TBD	ALL OTHER DISTURBED AREAS WITH PASPALUM NOTATUM - BAHIA SOD, NOTED AS "BAHIA SOD" ON PLAN. CONTRACTOR TO VERIFY AND SUBMIT QUANTITIES.
MULCH	TBD	FORESTRY SERVICES COLLIER COUNTY BROWN, OLD FLORIDA BLEND MULCH, OR APPROVED OTHER HARDWOOD MULCH NO CYPRESS MULCH PERMITTED SHREDDED, 3" THICK, ALL PLANT BEDS AND TREES RINGS (4") DIAMETER WITHIN SOD BEDS. CONTRACTOR TO VERIFY AND SUBMIT QUANTITIES.
ROOT	TBD	ROOT BARRIER TO BE INSTALLED AS NECESSARY. SEE DETAILS SHEET FOR INFORMATION. CONTRACTOR TO VERIFY AND SUBMIT QUANTITIES.
BOULDER	TBD	INSTALL PER PLAN, COORDINATE WITH CITY/LA.



GradyMinor
Civil Engineers
Landscape Architects
Land Surveyors
Planners

Bonita Springs 239.947.1144
Fort Myers 239.690.4380

www.GradyMinor.com

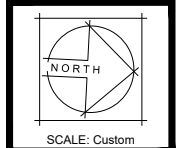
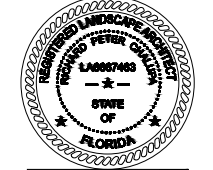

CHARLIE C. ANTHONY PARK
 PLANTING SCHEDULE
 CITY OF NAPLES, FL

G:\LANDSCAPE\C\014-ANTHONY PARK\DWGS\BETTERMENT\014-LA-BTR.DWG 5/2/2022 8:55 AM

REVISIONS



GradyMinor
Civil Engineers
Landscape Architects
Land Surveyors
Planners

Bonita Springs 239.947.1144
Fort Myers 239.690.4380

www.GradyMinor.com



CHARLIE C. ANTHONY PARK
DETAILS SHEET
CITY OF NAPLES, FL

NO.	REVISIONS

SHEET 5 OF 5

DATE: MAY 2022

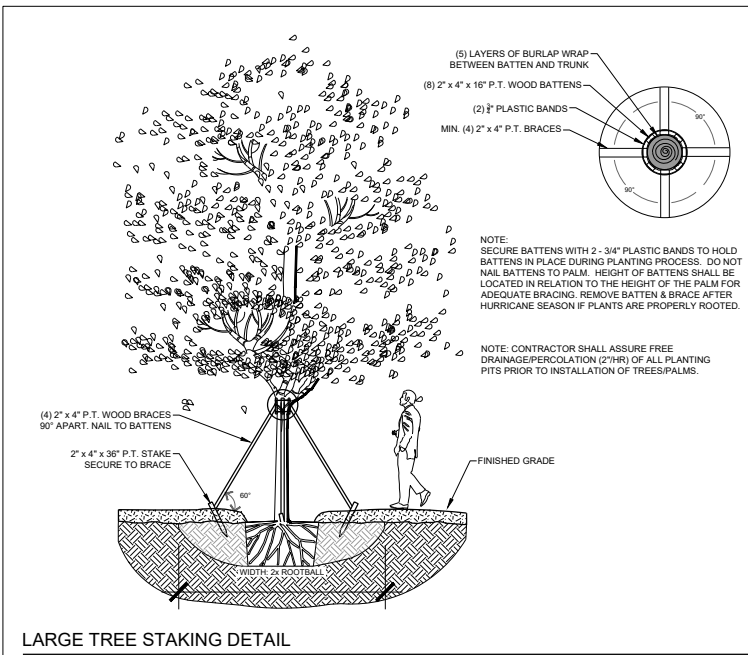

LARGE TREE STAKING DETAIL

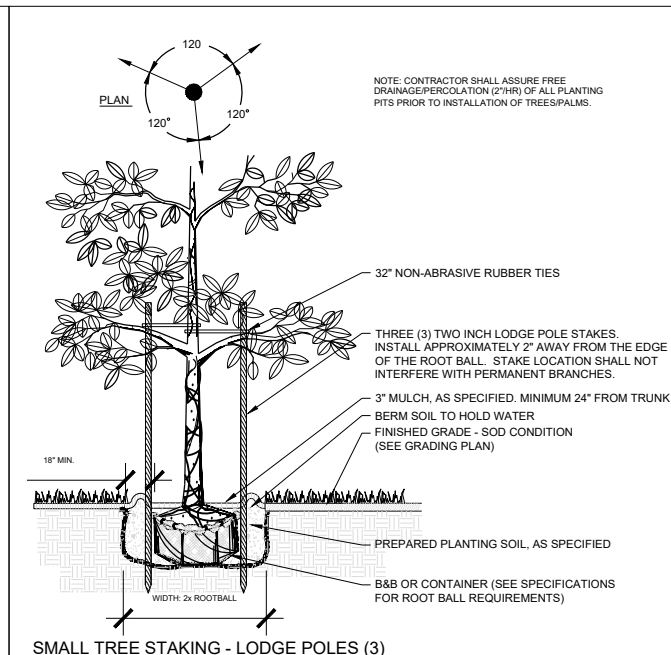

SMALL TREE STAKING - LODGE POLES (3)

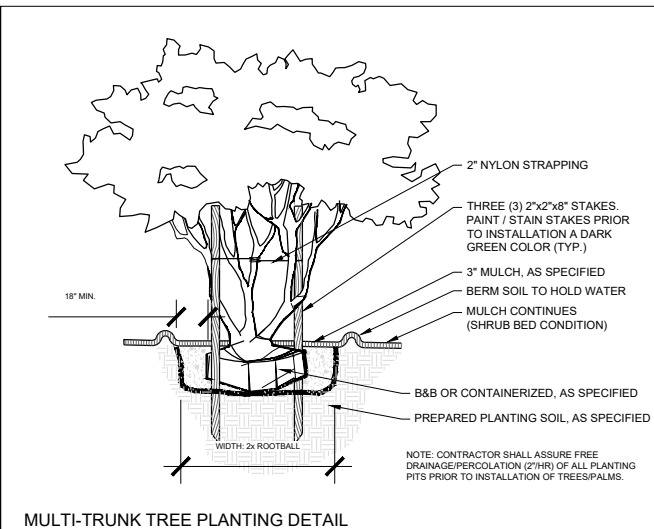

MULTI-TRUNK TREE PLANTING DETAIL

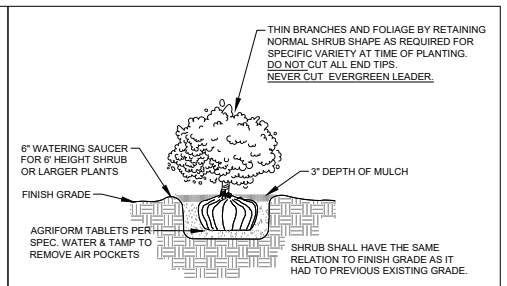

LARGE SHRUB PLANTING DETAIL

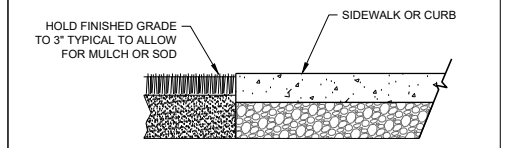

SOD / MULCH AT PAVEMENT EDGE

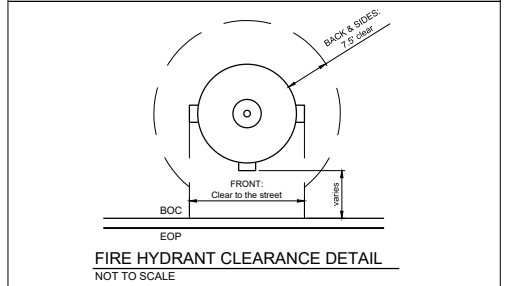

FIRE HYDRANT CLEARANCE DETAIL

LANDSCAPE INSTALLATION NOTES:

- ALL PLANT MATERIAL MUST BE FLORIDA NO. 1.
- ALL PLANTS SHALL BE FERTILIZED WITH AGRIFORM 20-10-5 TABLETS AS PER THE MANUFACTURER'S SPECIFICATIONS IN CONJUNCTION WITH NOTE #3.
- THE PLANTING SOIL SHALL BE THE APPROXIMATE PROPORTIONS AS FOLLOWS: 50% SAND AND 50% ORGANIC MATERIAL CONSISTING OF NATIVE PEAT, WELL DECOMPOSED SAWDUST, LEAF MOLD AND TOP SOIL. IT SHALL PROVIDE A GOOD PLIABLE AND THOROUGHLY MIXED MEDIUM WITH ADEQUATE AERATION, DRAINAGE AND WATER-HOLDING CAPACITY. IT SHALL ALSO BE FREE OF ALL EXTRANEIOUS DEBRIS, SUCH AS ROOTS, STONES, WEEDS, ETC.
- A SET OF CONSTRUCTION DOCUMENTS AND/OR APPROVED CODE-REQUIRED PLANS SHALL BE ON SITE AT ALL TIMES.
- ALL UTILITIES, EASEMENTS, RIGHT-OF-WAY, OWNERSHIP, AND/OR OTHER SURVEY DATA SHALL BE VERIFIED BY THE GENERAL CONTRACTOR, SITE WORK CONTRACTOR, AND/OR LANDSCAPE CONTRACTOR PRIOR TO THE COMMENCEMENT OF WORK.
- COMPLIANCE / PERMIT ACQUISITION AND/OR DISPLAY IS REQUIRED FOR CODE-RELEVANT REQUIREMENTS (SUCH AS, BUT NOT LIMITED TO: REMOVALS, TRIMMING, REPLACEMENT, ETC.).
- VERIFY PLANT QUANTITIES AND SPECIFICATIONS WITH THE LANDSCAPE ARCHITECT (ALSO REFERENCED AS "L.A." HEREAFTER). NOTIFY THE LANDSCAPE ARCHITECT IMMEDIATELY IF DISCREPANCIES ARE NOTED. PLANTING PLAN SHALL TAKE PRECEDENCE OVER 'PLANT LIST QUANTITIES'. THE L.A. RESERVES THE RIGHT FOR MATERIAL REJECTION IF THE INSTALLATION DOES NOT CORRESPOND TO THE PLANTING PLAN.
- PLANT MATERIAL IS TO BE FLORIDA GRADE #1 MINIMUM AND FLORIDA FANCY FOR PLANT MATERIAL SPECIFIED AS "SPECIMEN". TREES ARE TO BE CONSIDERED SINGLE TRUNK AND MEET THE MINIMUM STANDARD FOR CODE WITHIN THE APPLICABLE JURISDICTION.
- SIZES/SPECIFICATIONS ARE CONSIDERED MINIMUM. INSTALLATION MATERIAL IS TO MEET OR EXCEED THESE REQUIREMENTS - VERIFY ANY DISCREPANCY PRIOR TO MATERIAL PURCHASE, DELIVERY, AND/OR INSTALLATION.
- THE LANDSCAPE CONTRACTOR SHALL VERIFY THE LOCATION OF PLANT MATERIAL WITH THE LANDSCAPE ARCHITECT PRIOR TO INSTALLATION - CONTRACT THE L.A. FOR SPECIFIC GUIDELINES. IF A SITE CONFLICT / POTENTIAL IS NOTED, NOTIFY THE LANDSCAPE ARCHITECT PRIOR TO MATERIAL INSTALLATION. THE L.A. RESERVES THE RIGHT FOR MATERIAL RELOCATION IF THE INSTALLATION DOES NOT CORRESPOND TO THE PLANTING PLAN.
- THE LANDSCAPE CONTRACTOR AND/OR IRRIGATION CONTRACTOR SHALL BE RESPONSIBLE FOR DAMAGED SITE UTILITIES, INFRASTRUCTURE, ETC. REPAIR / REPLACE SHALL BE A REQUIREMENT.
- VERIFY SITE REMOVALS, RELOCATIONS, AND/OR PROTECTED ITEMS PRIOR TO BID PREPARATION. THIS MAY INCLUDE BUT NOT BE LIMITED TO: SOD, SOIL, PLANT MATERIAL, STUMPS, ETC. THE LANDSCAPE CONTRACTOR SHALL BE REQUIRED TO COMPLETE WORK AS OUTLINED WITH THE PLANTING PLAN(S), SPECIFICATIONS, AND NOTES.
- QUANTITIES AND SPECIFICATION ARE SUBJECT TO ADJUSTMENT, RELOCATION, AND/OR REMOVAL DURING OR AFTER THE INSTALLATION AND SUBSEQUENT APPROVAL PROCESS BY THE L.A.
- CONTRACTOR AND /OR LANDSCAPE CONTRACTOR SHALL REMOVE ALL EXOTIC(S) OR NUISANCE PLANTS AS DEFINED BY THE LOCAL AGENCY(IES) WHICH SHALL SUPERCEDE STATE REQUIREMENTS; HOWEVER, THE FLORIDA EXOTIC PEST PLANT COUNCIL (FLEPPC) AND/OR UF-IFAS STANDARDS SHALL BE USED AS A DATABASE TO JUSTIFY REMOVALS IF NO LOCAL ORDINANCE/CODE REQUIREMENT EXISTS.
- THE LANDSCAPE CONTRACTOR SHALL EXECUTE PRUNING VIA A CERTIFIED ARBORIST AND USING STANDARDS AS ESTABLISHED BY THE INTERNATIONAL SOCIETY OF ARBORICULTURE. ALL PRUNING, UPON REQUEST, SHALL BE ADVISED BY THE L.A.
- TREES AND PALMS OVER 9' IN HEIGHT SHALL BE STAKED.
- THE LANDSCAPE CONTRACTOR AND/OR IRRIGATION CONTRACTOR SHALL BE RESPONSIBLE FOR:
 - A. PLANT WARRANTIES AND REPLACEMENTS, AS SPECIFIED WITHIN THEIR RESPECTIVE AGREEMENT(S)
 - B. PLANT MATERIAL MAINTENANCE UNTIL "SUBSTANTIAL COMPLETION"
 - C. PLANT MATERIAL PROTECTION ADEQUACY
 - D. SCOPE OF WORK VERIFICATION AND EXECUTION
 - E. COORDINATION OF ALL SUBCONTRACTOR(S)
- THE OWNER / GENERAL CONTRACTOR SHALL BE RESPONSIBLE FOR: 1- PROVIDING FINAL GRADE, SITE ACCESS, SECURITY OF THE SITE 2- CONTRACT REVIEW AND ACCEPTANCE OF TERMS 3- PLANT / IRRIGATION MAINTENANCE COORDINATION 4- PAYMENT MILESTONES.
- IRRIGATION SYSTEM REQUIRES BACK FLOW PREVENTION. ASSURE EXISTING BACK FLOW PREVENTION IS FUNCTIONAL AND/OR INSTALL A NEW BACK FLOW PREVENTION PER COUNTY REQUIREMENTS. CONTRACTOR SHALL FIELD VERIFY SIZE AND LOCATION.

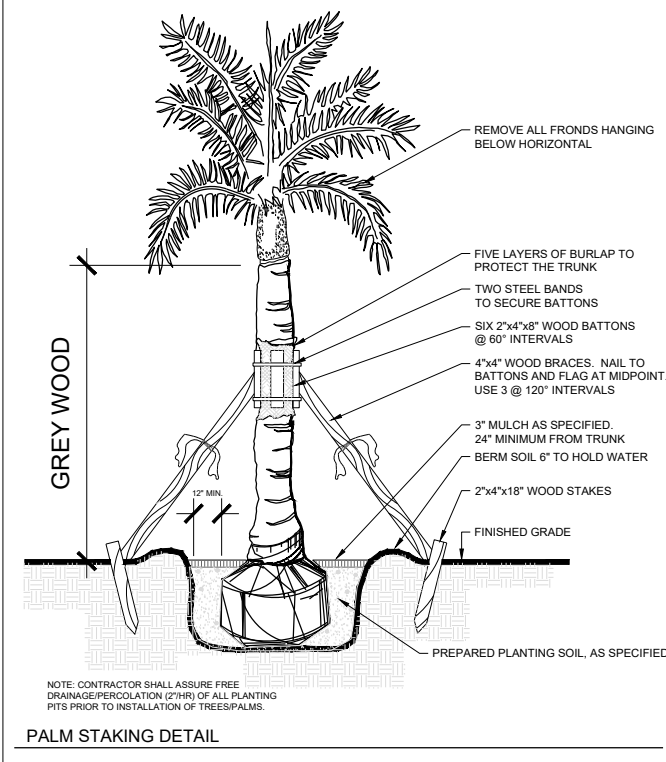

PALM STAKING DETAIL

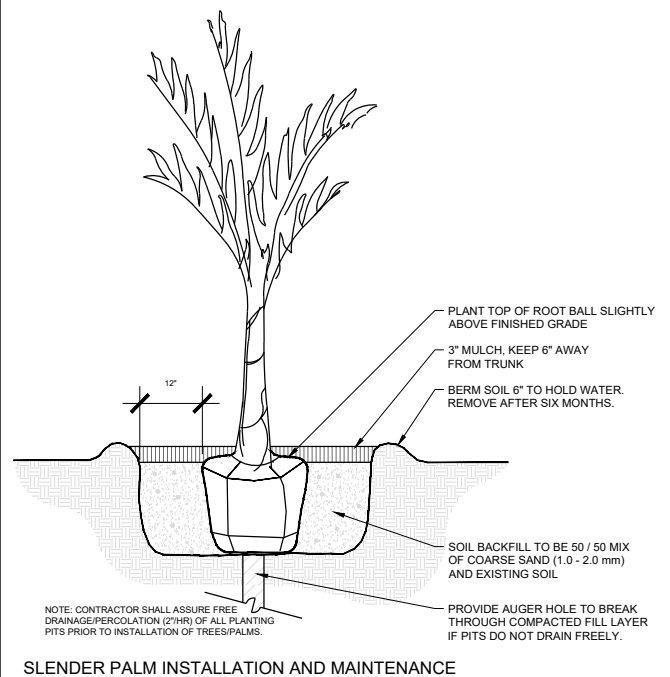

SLENDER PALM INSTALLATION AND MAINTENANCE

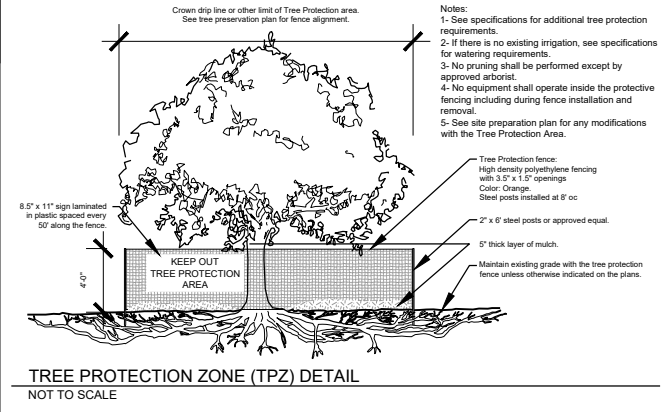

TREE PROTECTION ZONE (TPZ) DETAIL

SPECIES TO BE REMOVED

Botanical Name:	Common Name:
Abrus precatorius	Rosary Pea
Acacia auticuliformis	Earleaf Acacia
Albizia lebeck	Woman's Tongue
Araucaria heterophylla	Norfolk Island Pine
Bischofia javanica	Cuban Laurel
Casuarina spp.	Australian Pine
Colubrina asiatica	Lather Leaf
Cupianopsis anacardioides	Carrotwood
Dioscorea alata	Winged Yam
Dioscorea bulbifera	Air Potato
Lantana camara	Lantana
Leucaena leucocephala	Lead Tree
Lygodium spp.	Climbing Fern
Melaleuca quinquenervia	Melaleuca
Mimosa pigra	Catclaw Mimosa
Panicum maximum	Guinea Grass
Rhodomyrtus tomentosus	Downy Rosemyrtle
Scaevola taccada	Scaevola Beach Naupaka
Schinus terebinthifolius	Brazilian Pepper
Solanum viarum	Tropical Soda Apples
Syzygium cumini	Java Plum
Thespesia populnea	Seaside Mahoe
Urena Lobata	Cassia-weed

PROHIBITED SPECIES LIST

Botanical Name:	Common Name:
Cestrum diurnum	Day-blooming Jasmine
Eucalyptus camaldulensis	Murray Red Gum
Eugenia uniflora	Sour Cherry
Ficus benjamina	Benjamin Fig
Ficus microcarpa	Cuban Laurel
Dalbergia sissoo	Rosewood
Koeleria elegans	Golden Raintree
Ligustrum lucidum	Glossy Privet
Ligustrum sinense	Chinese Ligustrum
Melia azederach	Chinaberry
Paidium cattleianum	Strawberry Guava
Paidium guajava	Common Guava
Sapium sebiferum	Chinese Tallow
Syzygium jambos	Rose Apple
Thespesia populnea	Cork Tree
Wedelia trilobata	Wedelia

SEE ALSO, NOTE #14 IN THE LANDSCAPE INSTALLATION NOTES FOR ADDITIONAL EXOTIC PLANT RESOURCE(S).

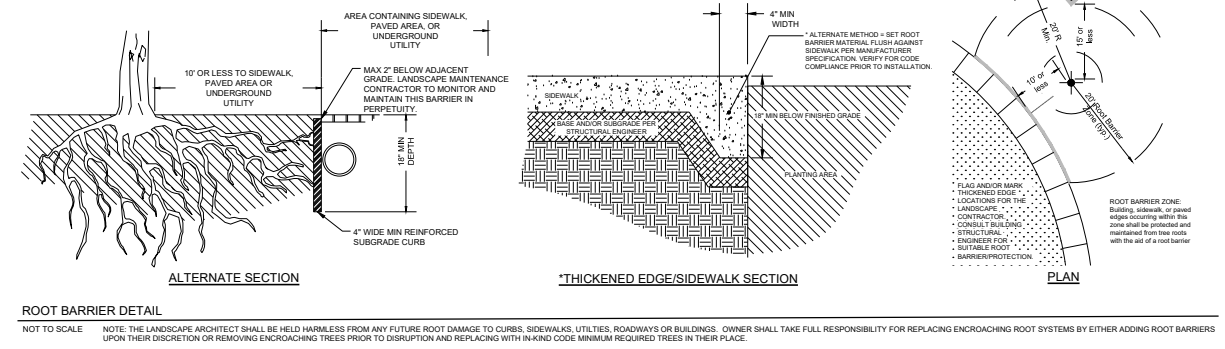

ROOT BARRIER DETAIL